

DESCRIPTION

The MB-23B bracket is used to mount a two-unit size component that is 420 mm (16.54") in width in a component rack.

SPECIFICATIONS

Color	Black
Weight	0.21 kg (0.46 lb)
Accessories	Binding head screw M4.....4 Flat washer 4.....4 S tight M5 screw.....4 Fiber washer 5.....4

APPEARANCE

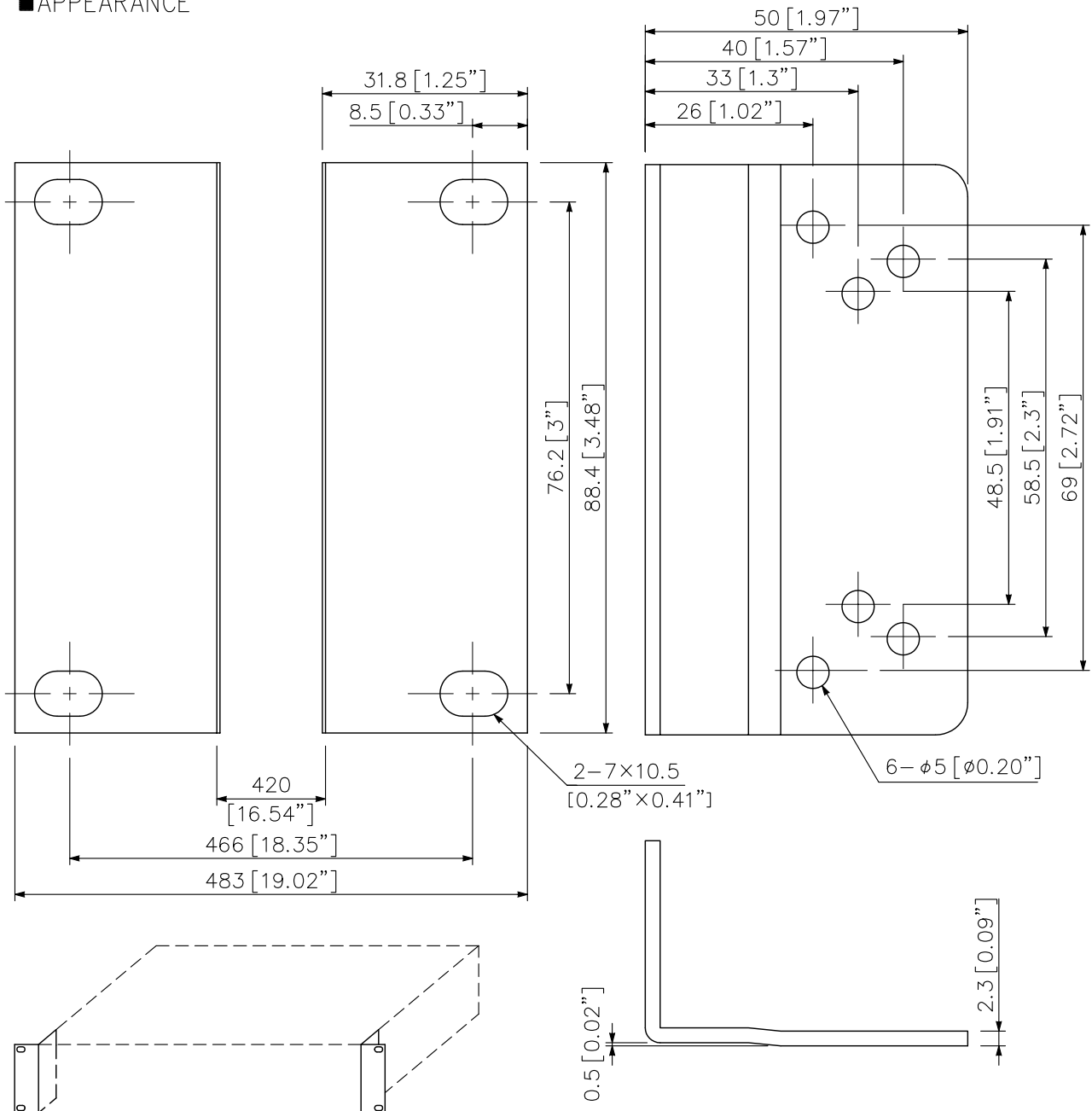

How to use joint bracket

UNIT:mm SCALE:1/1